

- Carpark Trees**
Ulmus parvifolia 'Todd'
Tristanopsis laurina with vegetated swales
- Feature Trees**
Acer rubrum 'Somerset'
Acer rubrum 'October Glory'
Acer platanoides 'Crimson Sentry'
Pyrus betulaefolia 'Southworth Dancer'
Jacaranda mimosifolia
- Drainage reserve trees**
Indigenous *Eucalyptus* and *Acacia* species
- Timber platform**
with gabion seating walls along shared path
- Drainage reserve**
- Dry creek bed**
Swathes of planting with timber boardwalk
- Main Street Trees**
Platanus x acerifolia
- Grass**
- Timber seating platform**
- Playground**



Scale (A3) 1:2000





Section A-A'



Section B-B'

Scale (A3) 1:200

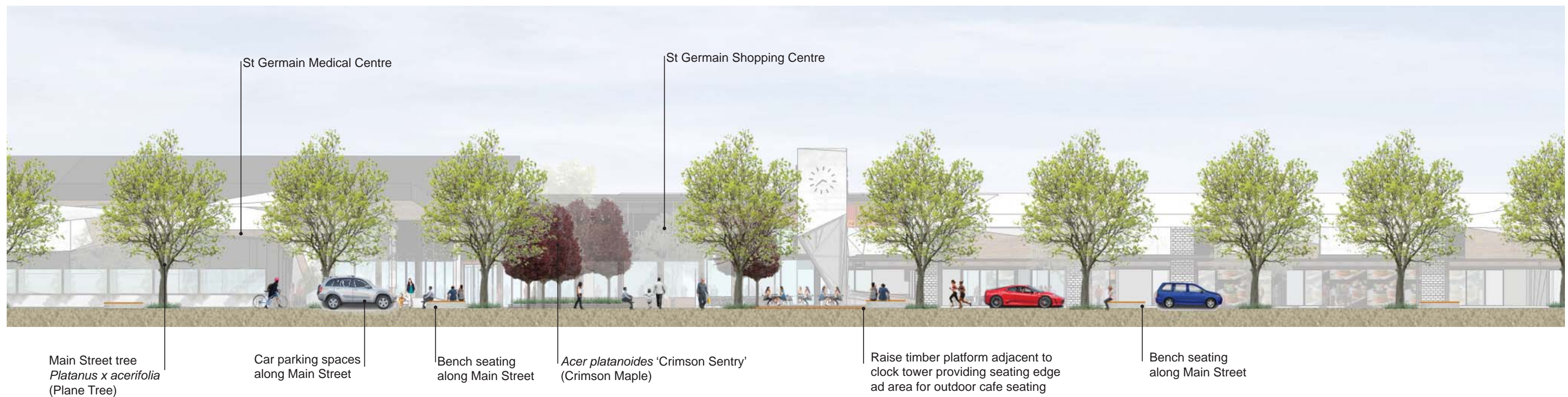
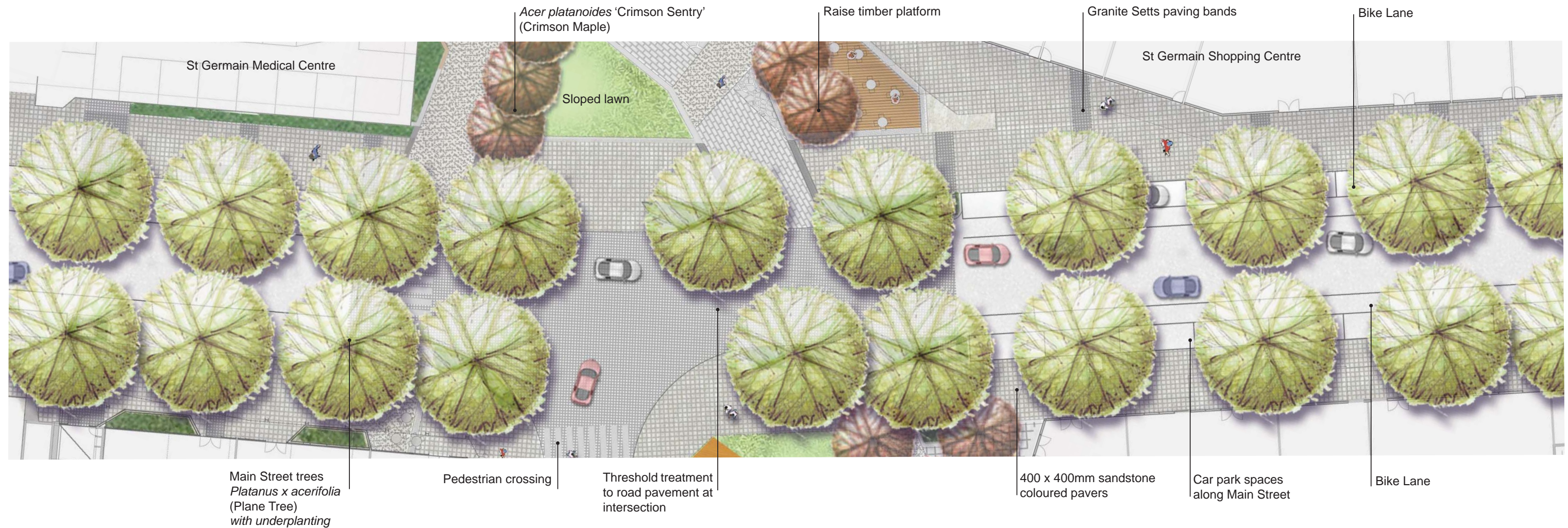

- Carpark Trees**
Ulmus parvifolia 'Todd'
Tristanopsis laurina with vegetated swales
- Feature Trees**
Acer rubrum 'Somerset'
Acer rubrum 'October Glory'
Acer platanoides 'Crimson Sentry'
Pyrus betulaefolia 'Southworth Dancer'
Jacaranda mimosifolia
- Drainage reserve trees**
Indigenous *Eucalyptus* and *Acacia* species
- Timber platform**
with gabion seating walls along shared path
- Drainage reserve**
- Dry creek bed**
Swathes of planting with timber boardwalk
- Main Street Trees**
Platanus x acerifolia
- Grass**
- Timber seating platform**



Street tree



Small tree



Medium shrub



Garden bed



CODE	BOTANICAL NAME	COMMON NAME	HEIGHT x WIDTH
DRAINAGE RESERVE TREES			
A.me.	Acacia melanoxylon	Blackwood	8-12 x 6-9 m
A.m.	Acacia mearnsii	Black Wattle	5-15 x 3-8 m
A.v.	Acacia verticillata	Prickly Moses	2-6 x 3-5 m
B.i.	Banksia integrifolia	Coast Banksia	8-10 x 3-5 m
E.l.	Eucalyptus radiata subsp radiata	Narrow-leafed Peppermint	10-30 x 6-20 m
E.EC	Eucalyptus viminalis subsp. pryoriana	Gippsland Manna gum	8-16 x 5-12 m
E.o.	Eucalyptus ovata	Swamp gum	10-16 x 8-12 m

PLANT SCHEDULE

	CODE	BOTANICAL NAME	COMMON NAME	HEIGHT x WIDTH
TREES				
	A.r.S.	Acer rubrum 'Somerset'	Somerset Maple	9 x 6 m
	A.r.O.	Acer rubrum 'October Glory'	Red Maple	12 x 9 m
	A.p.	Acer platanoides 'Crimson Sentry'	Crimson Maple	7 x 4 m
	B.a.	Brachychiton acerifolius	Brachychiton	10 x 8 m
	J.m.	Jacaranda mimosifolia	Jacaranda	6 x 4 m
	P.a.	Pyrus calleryana 'Aristocrat'	Ornamental Pear	11 x 7 m
	P.o	Platanus x acerfolia	London Plane	15 x 10 m
	P.b.	Pyrus betulaefolia 'Southworth Dancer'	Ornamental Pear	7 x 4 m
	T.l.	Tristaniopsis laurina	Kanooka	6 x 5 m
	Q.c.	Quercus coccinea	Scarlet Oak	14 x 8 m
	U.p.	Ulmus parvifolia 'Todd'	Chinese Elm	10 x 8 m
LARGE SHRUBS (> 1.8m)				
	A.s.	Acmena smithii 'Minor'	Dwarf Lilly Pilly	5 x 2 m
	A.f.	Agonis flexuosa 'After Dark'	Burgundy Willow Myrtle	6 x 3 m
	C.H.	Callistemon 'Harkness'	Harkness Bottlebrush	5 x 4 m
	L.CG.	Letospermum 'Copper Glow'	Tea Tree	3 x 2 m
	P.m.	Philotheca myoporoides	Long-Leaf Wax Flower	2 x 2 m
MEDIUM SHRUBS (1 - 1.8m)				
	C.LJ.	Callistemon 'Little John'	Little John Bottlebrush	1.2 x 1 m
	C.t.	Choisya ternata	Mexican Orange Blossom	1.2 x 1.2 m
	C.cn.	Convolvulus cneorum	Silver Bush	1.2 x 1.2 m
	C.a.	Correa alba	White Native Fuschia	1.5 x 1.5 m
	C.p.	Correa pulchella	Salmon Native Fuschia	1 x 1 m
	L.SS.	Leucadendron 'Safari Sunset'	Safari Sunset Leucadendron	1.8 x 1.8 m
	R.S.	Raphiolepis 'Springtime'	Springtime Raphiolepis	1.5 x 1.5 m
	R.d.	Raphiolepis x delacourii	Indian Hawthorn	1.8 x 2 m
	W.l.	Westringia longifolia	Westringia	1.5 x 1 m
	W.WG.	Westringia 'Wynyabbie Gem'	Native Rosemary	1.5 x 1.5 m
SMALL SHRUBS & STRAPPY-LEAFED PLANTS (0.3 - 1m)				
	A.c.	Acacia cognata 'Limelight'	Limelight Dwarf Limelight	1 x 1 m
	C.PS.	Cordyline 'Pink Star'	Pink Cordyline	1 x 1 m
	C.DB.	Correa 'Dusky Bells'	Dusky Bells Correa	0.8 x 0.8 m
	C.OG.	Correa pulchella 'Orange Glow'	Orange Glow Correa	0.4 x 0.4 m
	C.r.	Cycas revoluta	Cycad	1 x 1 m
	D.c.	Dianella caerulea 'Little Jess'	Blue Flax Lily	0.3 x 0.3 m
	D.s.	Dianella 'Silver Streak'	Blue Flax Lily	0.4 x 0.4 m
	D.b.	Dietes bicolor	Fortnight Lily	1 x 1 m
	D.g.	Dietes grandiflora	Wild Iris	1 x 1 m
	E.PP.	Escallonia 'Pink Pixi'	Dwarf Escallonia	0.6 x 0.6 m
	G.r.	Grevillea rosmarinifolia 'Nana'	Dwarf grevillea	0.6 x 0.6 m
	L.l.	Lomandra longifolia	Spiney-headed Mat-rush	1 x 1 m
	L.m.	Liriope muscari 'Evergreen Giant'	Large Liriope	1 x 1 m
	L.T.	Lomandra 'Tanika'	Dwarf Lomandra	0.6 x 0.4 m
	M.c.	Metrosideros collina 'Tahini'	Dwarf Metrosideros	1 x 1 m
	R.SM.	Rahpiolepis 'Snow Maiden'	Raphiolepis	0.5 x 0.5 m
	S.r.	Strelitzia reginae	Bird of Paradise	1 x 1 m
LOW PLANTS, GROUND COVERS & CLIMBERS (< 0.3)				
	C.ro.	Carpobrutus rossii	Pigs Face	0.2 x 2 m
	J.c.	Juniperus conferta	Shore Juniper	0.6 x 1 m
	M.pa.	Myoporum parvifolium	Creeping Boobialla	0.4 x 2 m
	V.h.	Viola hederaceae	Native Violet	0.2 x 1 m